

HYUNDAI
POWER PRODUCTS

LEAF BLOWER HYB5200

Instruction Manual

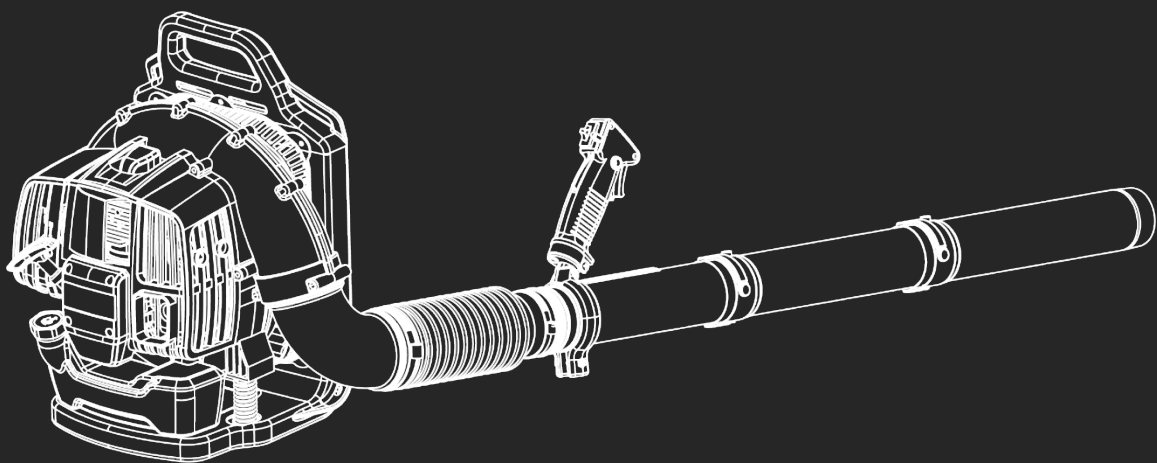

WARNING: Read the instructions carefully before use.

Contents

Introduction.....	3	Useful Information.....	41
Safety Information.....	4-14	Our YouTube Channel.....	41
Understand Your Machine.....	4	Warranty.....	41
Personal Safety.....	4-5	Manual Updates.....	41
Inspect Your Machine.....	5	Returning Your Product.....	41
Work Area.....	6	Leaving A Review.....	41
During Use.....	7	Ordering Spare Parts.....	41
Batteries.....	8	Product Record.....	42
Electricity.....	9	Contact Us.....	43
Vibrations.....	10		
Noise.....	10		
Engine Safety.....	11		
Carbon Monoxide.....	11		
Fuel Safety.....	12-13		
Personal Protective Equipment.....	14		
Unboxing.....	15		
Features.....	16-17		
Assembly.....	18-25		
Operation.....	26-31		
Fuelling.....	26		
Starting.....	27-29		
Stopping.....	30		
Throttle.....	31		
Maintenance & Care.....	32-36		
Air Filter.....	32-33		
Spark Plug.....	34-35		
Troubleshooting.....	36		
General Maintenance.....	37		
Storage.....	37		
Cleaning.....	37		
Specifications.....	38		
Recycling & Disposal.....	39		
Declaration Of Conformity.....	40		

Introduction

Thank You For Purchasing Your HYUNDAI Product

We work very hard to give all of our customers the best possible service. If you have any problems, before leaving negative feedback, please contact us to give us a chance to resolve the issue. We would be delighted if you left us positive feedback! Thank you for purchasing this product.

Important!



WARNING: READ THE INSTRUCTION BOOKLET THOROUGHLY BEFORE USING THE MACHINE. Keep for future reference and pass it on if the machine is loaned or sold to another user.

This manual has been produced by Hyundai Power Products and should be kept with the product. Please read and understand these instructions before you use your product. Failure to do this may result in personal injury or damage to the product.

The safety precautions and warnings are to ensure your safety and protect you from harm or damage to the product.

The information contained in this manual was accurate at the time of production, however HYUNDAI Power Products may make modifications to the product without notification.

Safety Information

Understand Your Machine

- **WARNING!** You must read these instructions carefully before operating the machine. Make sure that you are familiar with the controls and properly operate the machine. You must learn how to stop the machine quickly. If you do not follow the warnings and instructions, it may result in fire and/or serious injury. Make sure to save all warnings and instructions for future reference.
- Read this manual and labels affixed to the machine to understand its limitations and potential hazards.
- Be thoroughly familiar with the controls and their proper operation. Know how to stop the machine and disengage the controls quickly.
- If the unit is to be used by someone other than original purchaser, or is to be loaned, rented, or sold, always provide this manual and any needed safety training before operation. The user can prevent and is responsible for accidents or injuries that may occur to themselves, to other people, or to property.
- Do not force the machine beyond its limits. Use the correct machine for your application.
- Know how to stop the machine quickly in case of emergency. Understand the use of all controls.
- ALL MAINTENANCE other than that listed in this manual, should be carried out by professionally trained and certified personnel.
- When using this machine for the first time and before actual work, you **MUST** learn how to handle the machine from an experienced or skilled person.

Personal Safety

- **WARNING!** Never allow children or people unfamiliar with these instructions to use the product. Local regulations can restrict the minimum age of the operator.
- Keep children, pets, and other people not using the unit away from the work area (at least 15m). Be alert and shut off the unit if anyone enters work area. Keep children under the watchful care of a responsible adult.
- Stay alert, watch what you are doing and use common sense when operating the machine. Never operate the machine when unwell or tired, or if you have taken alcohol, medicine, drugs or any substances which may slow your reflexes and compromise judgment. A moment of inattention while operating the machine may result in serious personal injury.
- Appropriate Personal Protective Equipment (PPE), **MUST** be worn at all times when operating or repairing the machine. Always wear anti-slip and resistant work footwear and long trousers while using the machine. Do not use the machine when barefoot, wearing sandals or similar lightweight footwear. Do not wear chains, bracelets or clothing that is loose fitting or hanging ties or cords. Tie long hair back. Always wear protective earplugs. Loose clothes, jewellery, or long hair can be caught in moving parts. Protect eyes, face, and head from objects that may be thrown from the unit. Always wear safety goggles or safety glasses with side shields when operating.
- Always keep hands and feet away from all moving parts during operation. Moving parts can cut or crush body parts. Always keep hands and feet away from all pinch points.

Safety Information

Personal Safety (Continued)

- Do not touch parts that might be hot from operation. Allow parts to cool before attempting to maintain, adjust, or service.
- Do not overreach. Keep proper footing and balance at all times. This enables better control of the machine in unexpected situations. Extending your body too far can result in a loss of balance and you may fall which will result in injury.
- Never place any part of your body where it would be in danger if movement should occur during assembly, installation, and operation, maintenance, repairing or moving.
- Keep in mind that the operator or user is responsible for accidents, hazards or unexpected events involving the machine that occur to other people or their property. It is the responsibility of the user to assess the potential risk of the area where work is being carried out. The operator or user must take all necessary precautions to ensure their own safety and that of others, especially on slopes or rough, slippery and unstable ground.

Inspect Your Machine

- Check your machine before starting it. Keep guards in place and in working order. Make sure all nuts, bolts, etc., are securely tightened.
- You must check the general condition of the machine before use.
- Never operate the machine when it is in need of repair or is in poor mechanical condition. Replace damaged, missing, or failed parts before using it. Check for fuel leaks. Keep the machine in safe working condition.
- Do not use the machine if the machine's switch does not turn off the machine when running. Any machine that can't be controlled with the switch is dangerous and must be replaced.
- Regularly check to see that keys and adjusting wrenches are removed from the machine area before starting it. A wrench or a key that is left attached to a rotating part of the machine may result in personal injury.
- If the machine should start to vibrate abnormally, stop the machine and check immediately for the cause. Vibration is generally a warning sign of trouble.
- Avoid accidental starting. Be sure the switch is off before transporting the machine or performing any maintenance or service on the unit. Transporting or performing maintenance or service on a machine with its switch on invites accidents.
- Do not tamper with or disable safety systems.
- Only use manufacturer-recommended attachments.
- Before using, always visually inspect to see that the tools are not worn out or damaged. Replace worn out or damaged elements and bolts in set to preserve balance.
- Keep the machine in good operating condition. Operating the machine in poor or questionable condition could result in serious injury.
- Be sure all safety devices are in working order and warning labels are in place. These items are installed for your safety.

Safety Information

Work Area

- You must only work in daylight or with good artificial light in good visibility conditions. Do not work at night, at times of heavy fog, or at any other times when your field of vision might be limited and it would be difficult to gain a clear view of the area.
- Keep people, children and animals away from the working area.
- Operate on flat, level ground.
- DO NOT work on wet ground. If there has been heavy rain on the working site, wait until the ground has dried up.
- Never park the machine in a place with unstable ground which could give way.
- You must be careful near ravines, ditches or embankments.
- Exercise extreme caution when operating on or crossing gravel drives, walks, or roads. Stay alert for hidden hazards or traffic.
- Do not work in the rain, when there is a thunderstorm or lightning risk, at times of strong or gale force winds, or at any other times when the weather conditions might make it unsafe to use this product. If there is bad weather conditions, do not use the machine.
- Make sure you thoroughly inspect the entire work area and remove all objects and anything that could be thrown by the machine or could damage the machine (branches, stones, wire, toys, etc). Attempting to clear the work area whilst using the machine will reduce your concentration and creates a trip hazard. Any liquid spilled on the floor may result in you slipping.
- Find and locate all fixed objects in the ground, such as sprinkler systems, poles, water valves, bases for washing lines etc. Make sure that you check for hidden electrical cables or similar on the surface of the lawn. ALWAYS run the machine around these objects. NEVER run the machine over foreign objects.
- DO NOT operate power tools in explosive atmospheres, such as in the presence of flammable liquids, gases or dust. Power tools may create sparks, which may ignite the dust or fumes.
- This machine is only for outdoor use.

Safety Information

During Use

- Do not operate the machine in confined areas where there may be a risk of crushing the operator between the machine and another object.
- Never attempt to make any adjustments, while the machine is running.
- You must switch off the machine:
 - Before checking or working on the machine.
 - When transporting the machine.
 - Whenever you leave the machine unattended.
 - If the machine starts to vibrate abnormally.
- **WARNING!** If something breaks or an accident happens whilst working, you must turn off the machine immediately and move the machine away to prevent further damage. If an accident happens with injuries or third parties are injured, carry out the first aid measures most suitable for the situation immediately and contact the medical authorities for any necessary health care. Carefully remove any debris that might cause damage or harm persons or animals should it not be seen.
- After striking a foreign object, stop the machine immediately and inspect the machine thoroughly for damage. Repair the damage before continuing.
- Never operate the machine with damaged guards or without the guard in place.

Safety Information

Batteries (Where Present)

Batteries present a risk if they become damaged by the possible leaking of electrolyte. This electrolyte is an acid and can cause serious burn injuries. Care should be taken when working on or near them. **NOTE:** the electrolyte may be in a liquid or gel form.

Should you come in to contact with electrolyte you should;

- Remove all clothing contaminated with electrolyte. If you cannot remove then saturate them in water.
- Get medical assistance as soon as possible.

You must advise the medical staff of the type of acid.

- Lead/acid battery = dilute sulphuric acid.
- Nickel/cadmium = potassium hydroxide alkali electrolyte.
- Use fresh running water to wash off excess electrolyte, continue this until medical assistance arrives. Make sure that you do not wash the electrolyte to another part of your body or face.
- If electrolyte comes in to contact with Eyes the electrolyte needs to be immediately washed away with large amounts of water. Make sure that you do not wash the electrolyte to another part of your face or body.
- Gasses from charging batteries are highly flammable and great care should be taken to charge in well ventilated areas.



- There is an explosion risk if the battery terminals are short circuited, when connecting/disconnecting ALWAYS exercise great care so that the terminals or battery leads are NOT allowed to touch and cause a spark. ALWAYS use suitable insulated tools.

Safety Information

Electricity (Where Applicable)

DANGER : ELECTRICITY CAN KILL – NEVER WORK ON LIVE / ENERGISED EQUIPMENT.



- Prior to carrying out any maintenance work you **MUST** identify electrical isolation methods and isolate all electrical supplies.
- Prior to use and with all electrical supplies isolated, you **MUST** check all electrical cables, plugs and connectors for the following;
 - Are intact and have no signs of damage, to include but not limited to bare wires, chaffing, cuts and loose wiring.
 - If there are any signs of damage, the damaged item **MUST** be taken out of service until the damage has been repaired by an electrically competent person.
 - All trailing cables should be routed so as not to cause any kind of trip hazard.
 - **NEVER** work on or near electricity with wet hands, wet clothing and wet gloves.

Safety Information

Vibrations (Where Applicable)

- Prolonged use of hand held (operated) machines will cause the user to feel the effects of/from vibrations. These vibrations can lead to white finger (Raynaud's phenomenon) or carpal tunnel syndrome. This condition reduces the ability of the hand to feel and regulate temperature, causing numbness and heat sensations and may cause nerve damage and circulatory tissue death.
- Not all factors that lead to white finger disease are known, but cold weather, smoking and other diseases that affect blood vessels and blood circulation as well as large and long-lasting impact of shocks are considered factors in the formation of white finger. Note the following to reduce the risk of white finger and carpal tunnel syndrome;
 - Wear gloves and keep your hands warm.
 - Take regular breaks.
 - All of the above precautions may help reduce the risk of white finger disease but not rule out the carpal tunnel syndrome. Long-term and regular users are therefore recommended to observe the condition of your hands and fingers. Seek medical attention immediately if any of the above symptoms should occur.

Noise (Where Applicable)

- The operating noise of the machine can damage your hearing. When wearing protection such as earplugs or ear defenders to protect your hearing. Long-term and regular users are advised to have hearing checked regularly. Be especially vigilant and cautious when wearing ear protection because your ability to hear alarm warnings will be reduced.
- Noise emissions for this equipment is unavoidable. Carry out noisy work at approved times and for certain periods. Limit the working time to a minimum. For your personal protection and protection of people working nearby it is also advisable for them to wear hearing protection.



- See Certificate of Conformity section for Outdoor Noise declaration of conformity.

Safety Information

Engine Safety

- Never start or run the engine inside a closed area. The exhaust fumes are dangerous, containing carbon monoxide, an odourless and deadly gas. Operate this unit only in a well-ventilated outdoor area. (See carbon monoxide safety).
- Do not tamper with the engine in an effort to get it to run at higher speeds. The maximum engine speed is preset by the manufacturer and is within safety limits.
- Keep a fire extinguisher on hand when operating this machine in dry areas as a precautionary measure.
- Never leave the operating position when the engine is running.
- The engine parts get very hot when running, do not touch. Danger of burns.
- Follow the instructions to ignite the engine carefully whilst keeping feet away from moving parts.
- Do not over-rev the engine or change the engine settings.
- Stop the engine whenever you leave the machine, or before refuelling, when cleaning or while maintaining.
- Reduce the throttle setting during engine shut down and, if the engine is provided with a shut-off valve, turn the fuel off at the conclusion of working.

Carbon Monoxide

 WARNING! Engine exhaust fumes contain Carbon Monoxide. This is a poisonous gas and can kill in minutes. NEVER use inside a building or in an area with poor ventilation. NEVER use inside a confined space, such as but not limited to a house, garage, vehicle, boat or tent. ONLY use outside and far away from windows, doors and vents.

CARBON MONOXIDE IS A COLOURLESS, ODOURLESS GAS. INHALING THIS GAS CAN CAUSE DEATH OR SERIOUS LONG-TERM HEALTH PROBLEMS SUCH AS BRAIN DAMAGE.

Never operate the engine in a confined space where dangerous carbon monoxide fumes can develop. All ignition operations have to be effected in an open or well-ventilated area. Always remember that exhaust fumes are toxic.

The symptoms of carbon monoxide poisoning can include but are not limited to the following; Headaches, dizziness, nausea, breathlessness, collapsing or loss of consciousness.

Carbon monoxide poisoning symptoms are similar to flu, food poisoning, viral infections and simply tiredness. It is quite common for people to mistake this very dangerous poisoning for something else.

To avoid carbon monoxide poisoning **DO NOT** use Petrol/Diesel powered equipment inside any of the following; Home, garage, tent, camper van, mobile home, caravan or boat.

DO NOT use in an enclosed area or moving vehicle. This is not exhaustive and if you are in any doubt contact your dealer.

If you think you have or someone around you has been affected by carbon monoxide poisoning; Get them fresh air immediately, by leaving the affected area or by opening doors and windows. If safe and practical to do so make sure that the machine is turned off. **DO NOT** enter a room you suspect of having carbon monoxide present – instead call the emergency services.

Contact a Doctor immediately or go to Hospital – let them know that you suspect carbon monoxide poisoning.

Safety Information

Fuel Safety



General Safety

- Do not smoke each time fuel is handled.
- ALWAYS avoid inhaling fumes.
- ALWAYS carry fuel in the correct and clearly marked container.
- ALWAYS wear correct, suitable and fit for purpose Personal Protective Equipment (PPE), suggested items are but not limited to safety gloves and overalls.
- To avoid sparking or arcing, keep grounded conductive objects – such as tools – away from exposed, live electrical parts and connections. These events could ignite fumes or vapours.
- Do not operate the machine with known leaks in the fuel system.
- Fire hazard - keep fuel away from all sources of ignition for example heaters, lamps, sparks from grinding or welding.
- DO NOT carry out hot work on tanks that have contained fuel.
- ALWAYS keep the work area tidy.
- ALWAYS dispose of waste fuels correctly.
- Serious personal injury can occur when petrol is spilled on yourself or your clothes. Rinse your skin and change your clothes immediately.

Spilled Fuel

- If you have spilled fuel, make sure you do not attempt to ignite the engine but move the machine away from the area of spilled fuel and avoid creating any source of ignition until the fuel has evaporated and fuel vapours have dissipated.
- When fuel is spilled on yourself or your clothes, wash your skin and change clothes immediately.
- ALWAYS clean up spills promptly using absorbent granules and a lidded bin.

Fuelling / De-Fuelling

- ALWAYS fuel and de-fuel in a well ventilated area outside of buildings. Use a funnel to add fuel, only outdoors. Do not smoke during this and each time fuel is handled.
- Add fuel before igniting the engine, never remove the fuel tank cap or add fuel whilst the engine is running or when it is hot.
- When de-fueling ALWAYS use a proper fuel retriever.
- Never overfill the fuel tank. Engine heat can cause fuel to expand, never fill the tank to more than 1/2" below the bottom of the filler neck. This will provide space for fuel expansion.
- When refilling or draining the fuel tank, use an approved fuel storage container while in a clean, well-ventilated outdoor area. While adding fuel or operating the unit, do not smoke, and stay away from sparks, open flames, or other sources of ignition near the area of operation.
- Always stop the engine and allow it to cool before filling the fuel tank. Never remove the cap of the fuel tank or add fuel while the engine is running or when the engine is hot.
- Loosen the fuel tank cap slowly to relieve any pressure in the tank.
- ALWAYS keep the handles dry, clean and free of oil and fuel.
- After fueling, ensure to tighten the cap securely.
- Never use the lock-function when filling with fuel.

Fuel Safety (Continued)

Storage

- Store fuel in containers specifically designed and approved for fuel storage.
- Store fuel in a cool, well-ventilated area, safely away from sparks, open flames, or other sources of ignition.
- Never store fuel – or a machine with fuel in the tank – inside a building where fumes may reach a spark, open flame, or any other source of ignition (such as a water heater, furnace, or clothes dryer). Allow the engine to cool before storing in any enclosure.
- Replace all fuel tank and container caps securely and wipe up spilled fuel. Never operate the unit without the fuel cap securely in place.

Safety Information

Personal Protective Equipment

Appropriate Personal Protective Equipment (PPE), MUST be worn at all times when operating or repairing the machine. No protective equipment can ensure 100% protection.

When selecting PPE, make sure it's CE marked and it suits the user in terms of size, fit, etc. If more than one item of PPE is worn at the same time, make sure they can be used together, e.g. wearing safety glasses may disturb the seal of a respirator, causing air leaks.



Hand Protection Must Be Worn

Protective electrically non-conductive gloves are highly recommended when working.



Foot Protection Must Be Worn

Non-skid heavy duty footwear are highly recommended when working.



Hearing Protection Must Be Worn

Suitable safety hearing protection is recommended.



Eye Protection Must Be Worn

Always wear safety glasses/goggles and/or face shields. Everyday eyeglasses have only impact resistant lenses; they are not safety glasses/goggles.



Protective Clothing Must Be Worn

Do not wear loose clothing, gloves, scarfs, neckties or jewellery (rings, wrist watches), which can be caught in moving parts.



Head Protection Must Be Worn

Wear a safety helmet with a safety visor.



Face Shield Must Be Worn

Wear a face shield to protect your face.

Unboxing

⚠ WARNING : Unboxing and assembling the machine should be done on a flat, surface with enough room. Disposal of the packaging should be done in accordance with the local regulations in force.

⚠ WARNING : Some of the packaging material may be harmful to children. Keep out of reach of children.

1. Carefully remove the product from the packaging and examine it for any sign of damage caused during shipping.
2. Lay the contents out and check them. If any part is damaged or missing, you must not use the machine. Contact HYUNDAI POWER PRODUCTS immediately.
3. You must keep the packaging material in case the machine needs to be returned or repaired.
4. Ensure that you have all the accessories and tools you need for assembly and operation including the suitable personal protective equipment.

Features

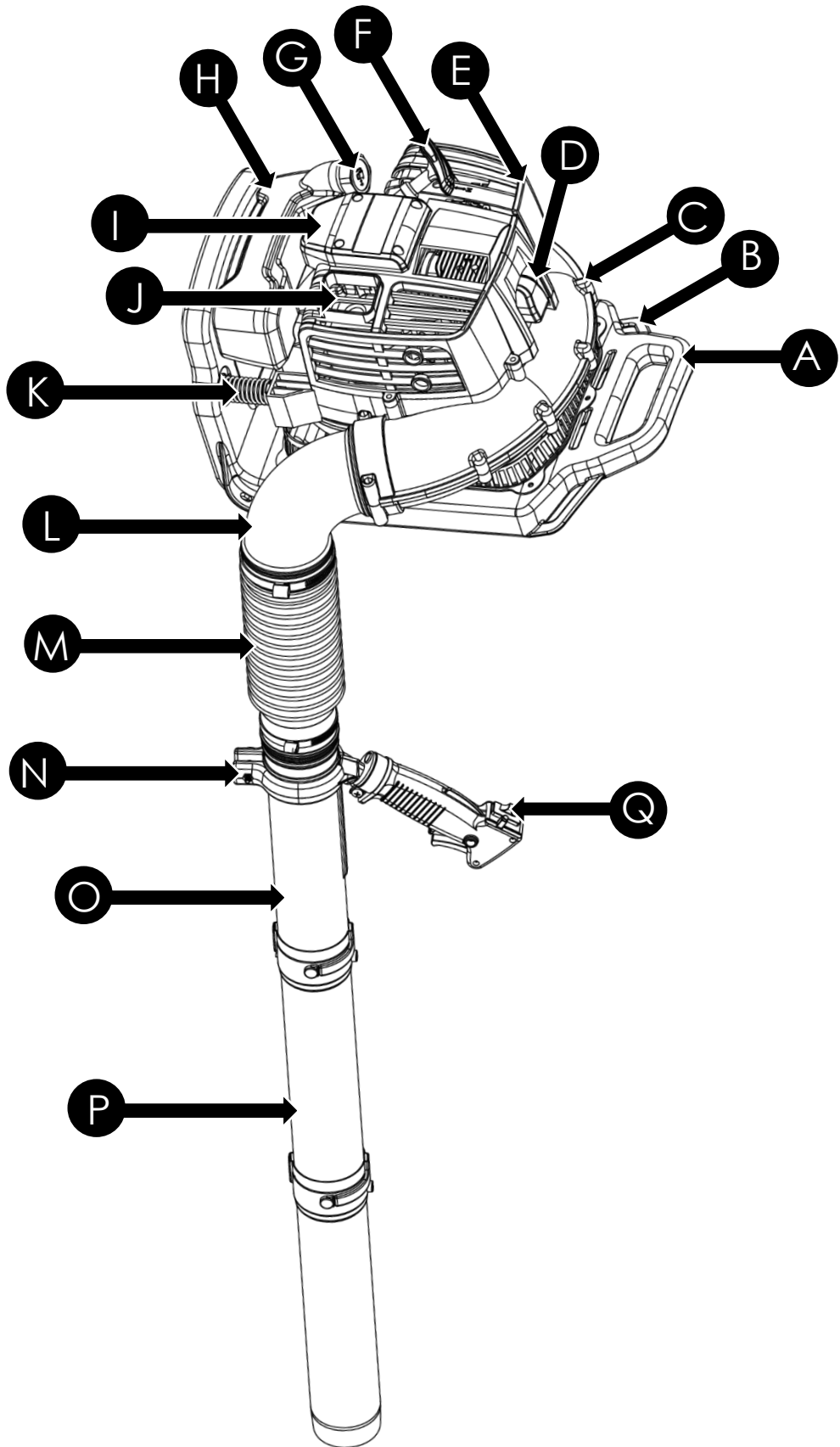

Descriptions on next page 

Features

- A** Frame
- B** Side Cover
- C** Blower Cover
- D** Spark Plug Cap
- E** Engine
- F** Starter Handle
- G** Fuel Cap
- H** Fuel Tank
- I** Recoil Assembly
- J** Exhaust
- K** Shock Absorber
- L** Blower Elbow
- M** Flexi-pipe
- N** Control Handle Clamp
- O** Swivel Pipe
- P** Mid-pipe and Pipe Nozzle
- Q** Control Handle

Assembly

STEP 1

⚠ WARNING! Do not add fuel to this machine before assembly. Fuel can spill during assembly which is hazardous.

1. Put the larger hose clip on the larger side of the Flexible-pipe.

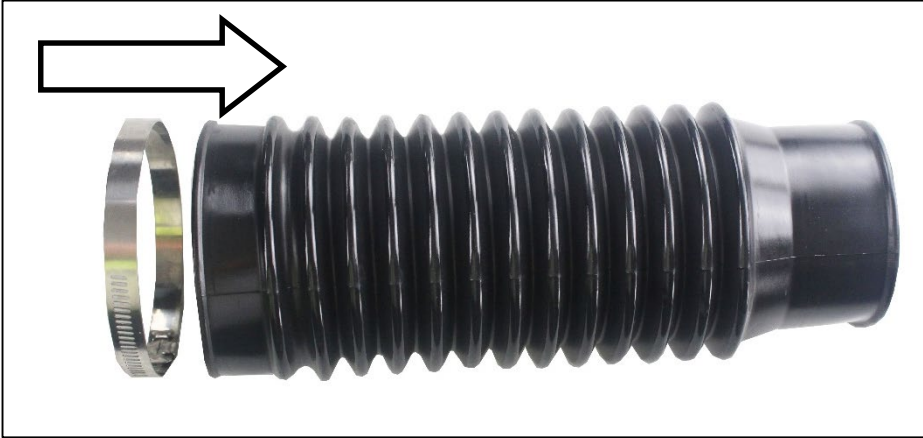

2. Attach the Flexible pipe to the Blower Elbow. Tighten the Hose clip - DO NOT overtighten, as once the threads on the hose clips are damaged they will no longer work.

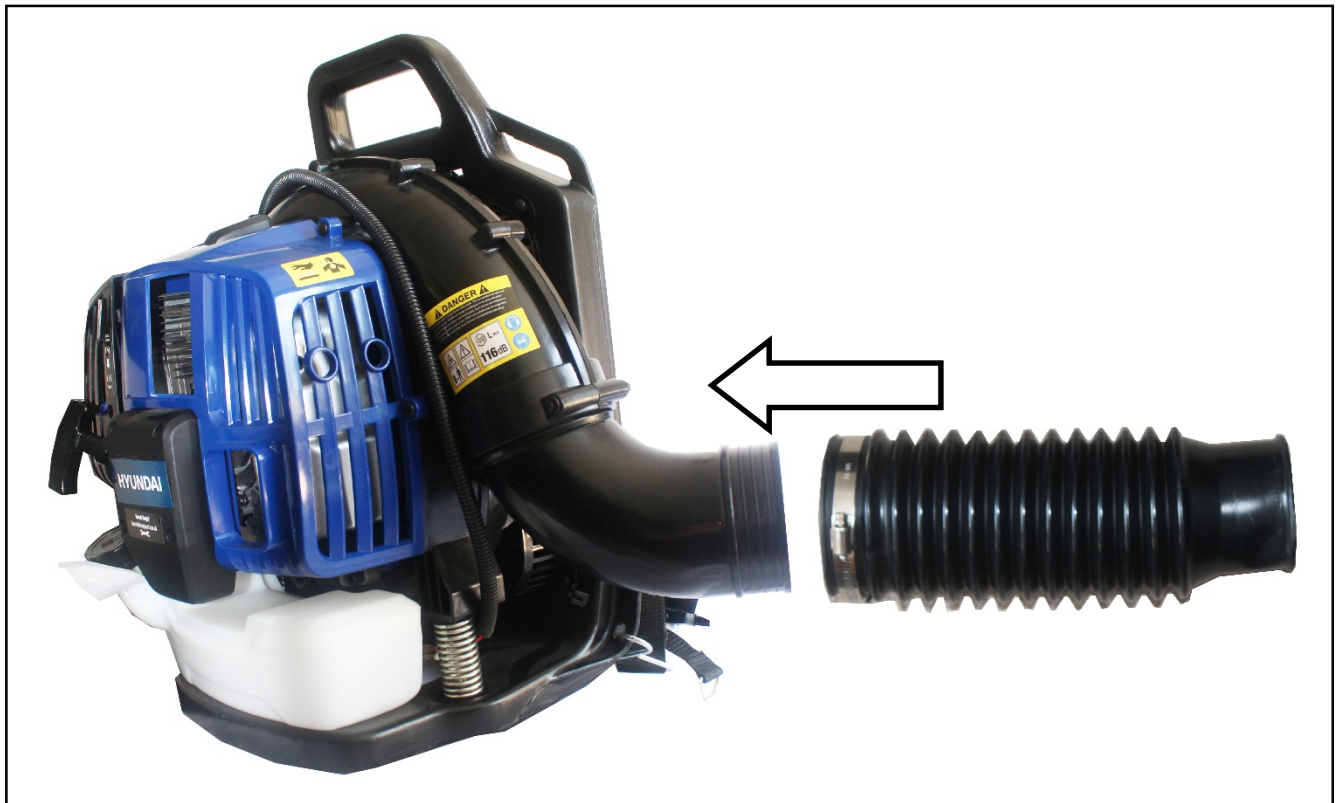

Continued on next page 

Assembly

STEP 1 (Continued)



Assembly

STEP 2

1. Loosen the Wing-nut on the Control Handle.
2. Insert the Control Handle over the Swivel Pipe.

! Ensure the notch on the Swivel Pipe, matches up with the Groove on the control Handle.



Continued on next page 

Assembly

STEP 2 (Continued)

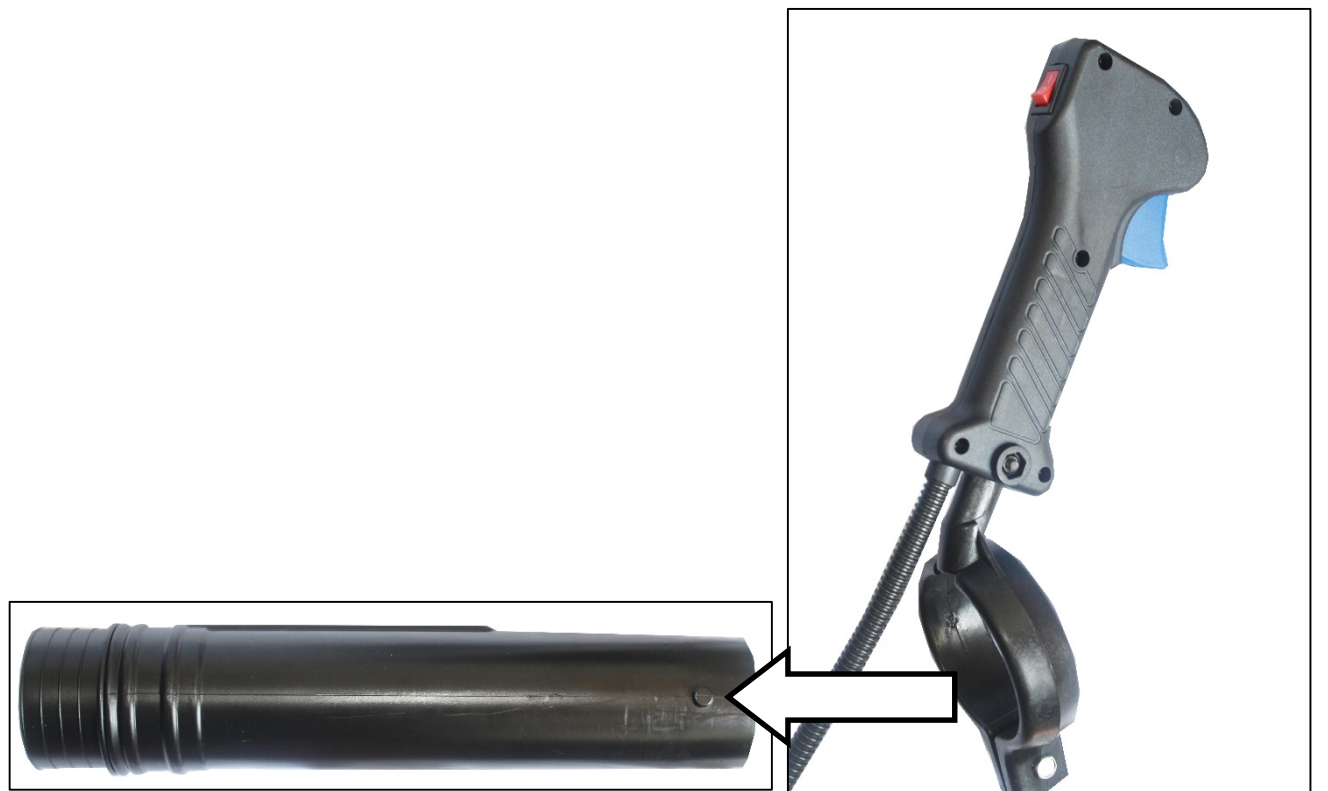

Assembly

STEP 3

1. Place the smaller hose clip over the smaller side of the flexible pipe.
2. Insert the Swivel pipe into the Flexible Pipe.
3. Tighten the Hose clip

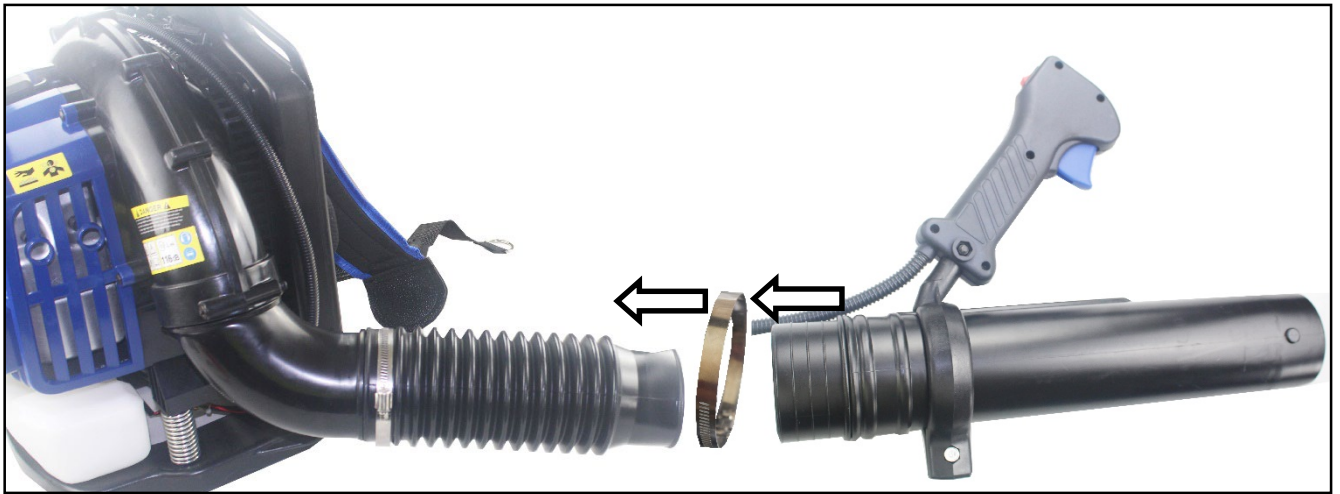

Assembly

STEP 4

1. Insert the Mid-pipe into the swivel pipe, line up the notches on the Swivel pipe, to the grooves on the Mid-pipe.

2. Twist together and tighten the screw to full secure the pipes together.

Repeat these step for the Pipe Nozzle.

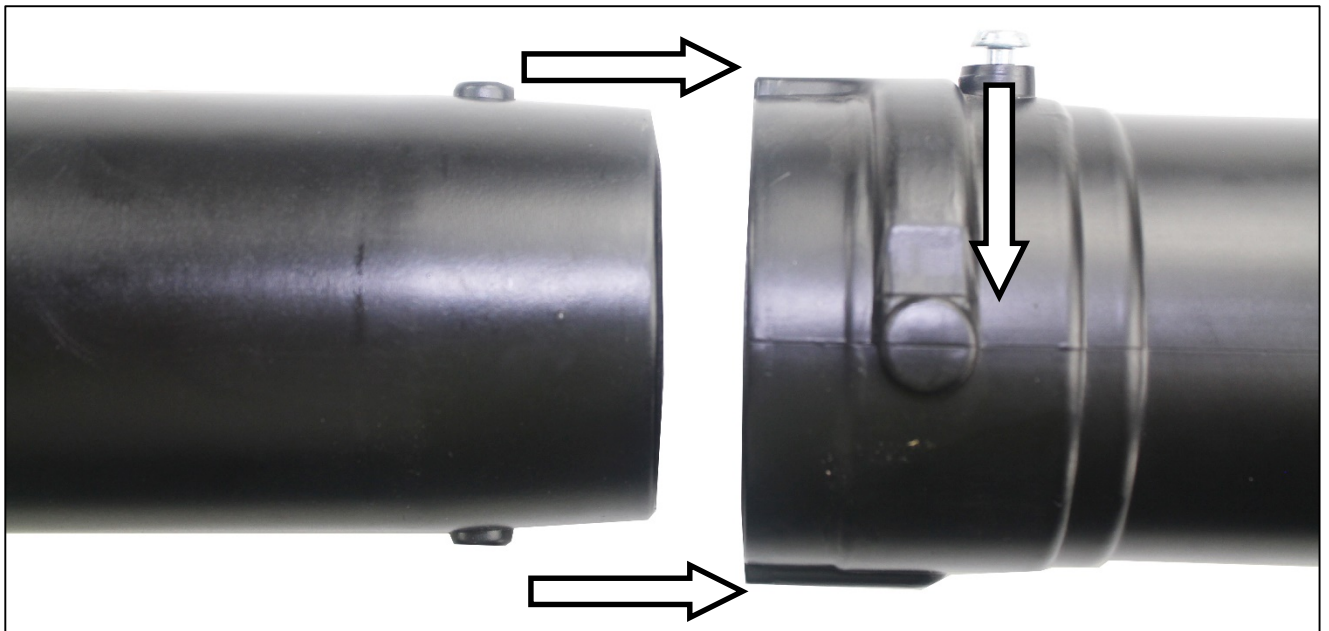
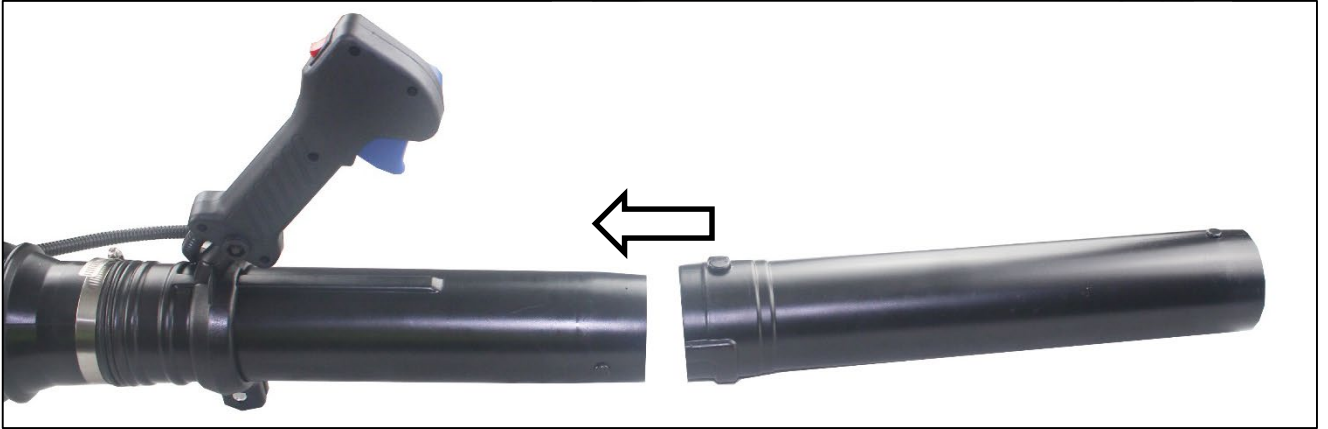

Continued on next page 

Assembly

STEP 4 (Continued)

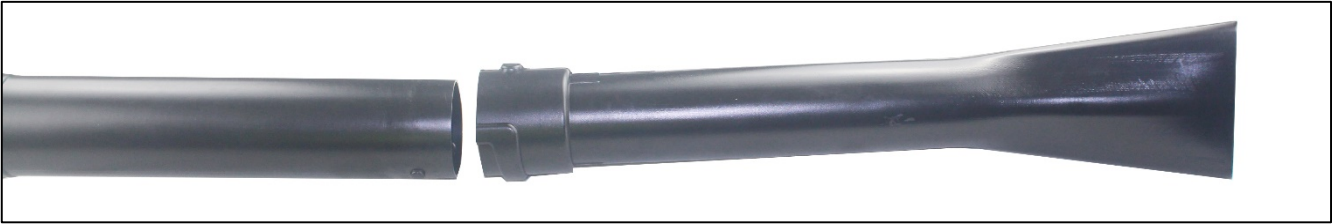

Assembly

STEP 5

1. Insert the Harness Hooks, through the holes in the Frame.
2. Repeat this on both sides of the frame.
3. Adjust the straps of the harness to appropriately support the machine during use.

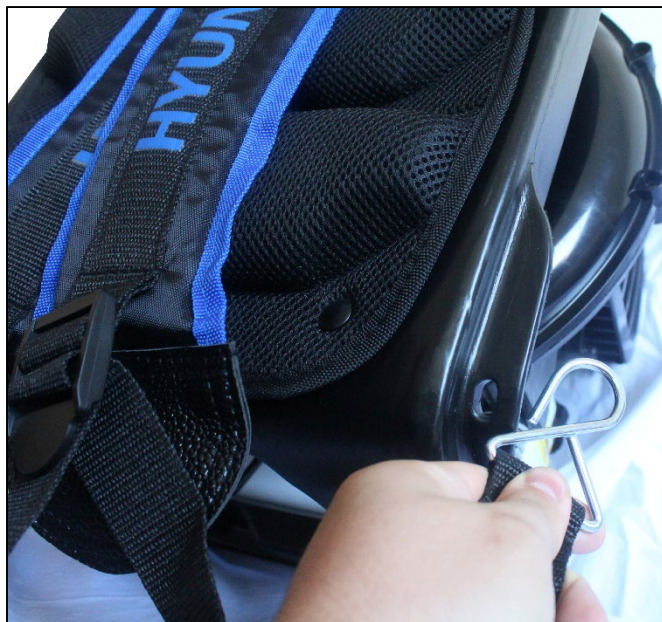

Operation

Fueling

⚠ WARNING! It's essential you **NEVER** use the machine with just unleaded petrol. This will cause permanent damage and void the products warranty.

⚠ WARNING! When pouring fuel/oil into the mixing bottle, use a funnel or pipe. Petrol is a Solvent and Volatile liquid.

⚠ WARNING! Always Fuel/Un-Fuel your machine in a well ventilated area.

Use a 40:1 Fuel Mix Ratio

1. Firstly pour 574ml of unleaded petrol into the mixing bottle.
2. Then add 14ml of Synthetic 2-stroke oil.
3. Shake the bottle for 1 minute to ensure thorough mixing.

! Never use a fuel mix that is older than 90 days.

4. Remove the Fuel cap and fill with the Fuel Mixture.



Operation

Starting

⚠ WARNING! Before operating the HYB5200 ensure you have read and fully understand the user manual.

! The HYB5200 uses an automatic spring loaded On/Off switch, located on the Control Handle. When starting the machine, the switch will always be in the ON position.

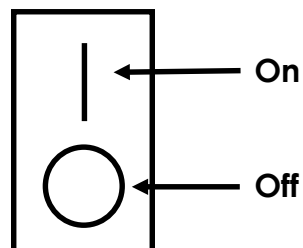

Cold Starting

1. Put the Choke Lever up in the "Cold Start" position.

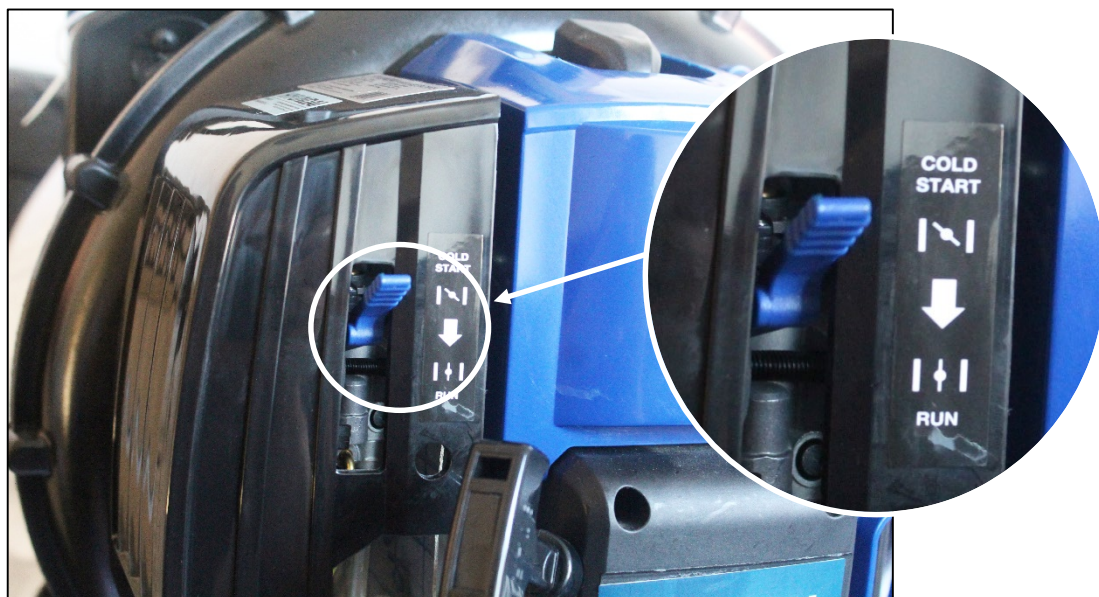

Continued on next page 

Operation

Starting (Continued)

2. Prepare the engine to start by pressing the Primer Bulb 10 times. This fills the carburettor with fuel preparing the machine to start.

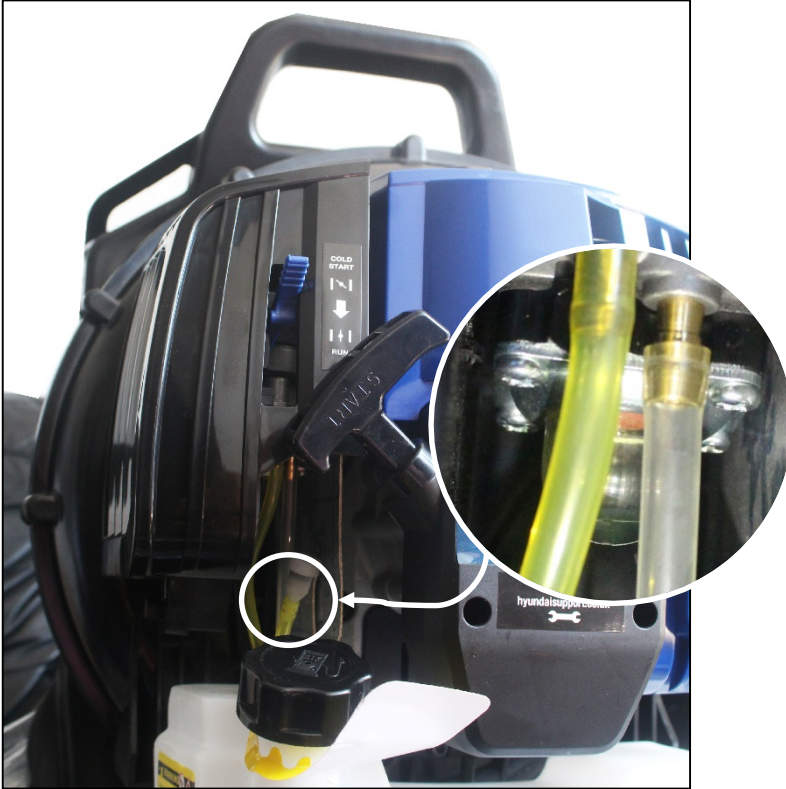

3. With a firm grip of the Starter Handle and the Frame, Pull the Recoil Starter 4-6 times.



4. When the machine starts, move the Choke Lever down in to the "Run Position". YOU MUST do this step, as the machine will over fuel and stop.

Starting (Continued)

Hot Starting

1. If the engine is hot, or has just been run, the Choke Lever must be kept in the run position.
2. With a firm grip of the Starter Handle and the Frame, Pull the Recoil Starter, it should start after 1-2 pulls.

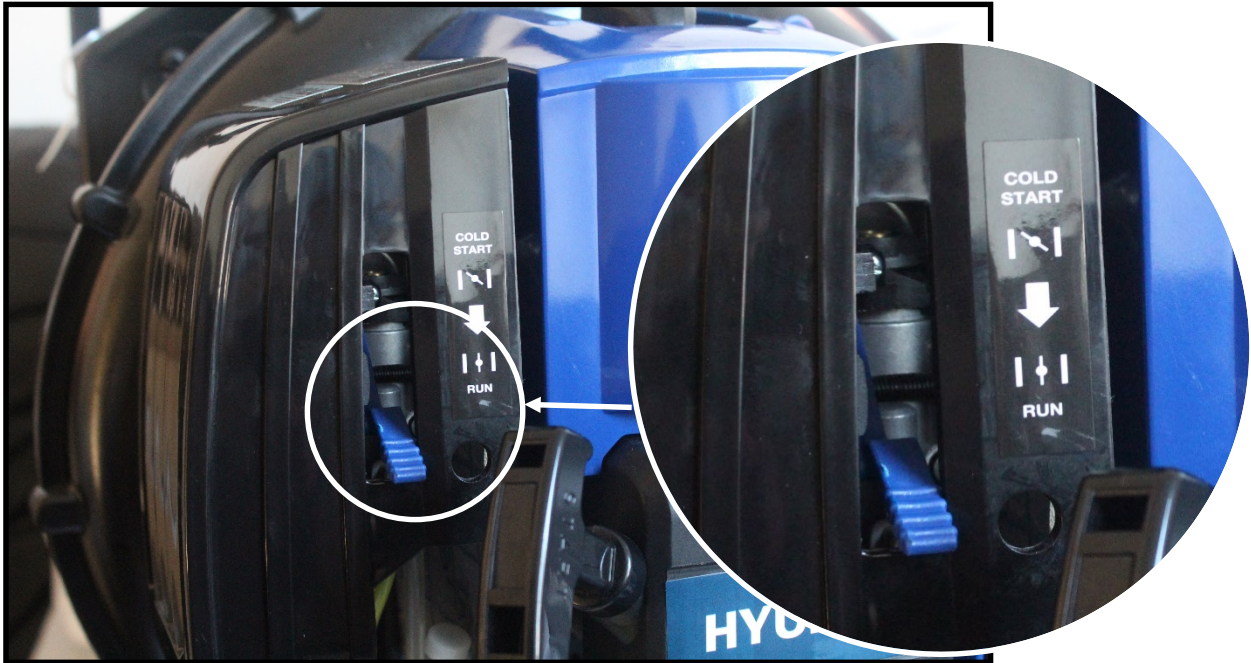

Operation

Stopping

To stop the Machine press the On/Off switch on the Control handle. This will instantly cut the power of the HYB5200.

If the machine fails to stop, please contact us at 01646 687 880 or <https://hyundaipowerequipment.co.uk/support>

When putting the machine on whilst started, try not to tip it too much from side to side. This can cause fuel to leak through the carburettor.

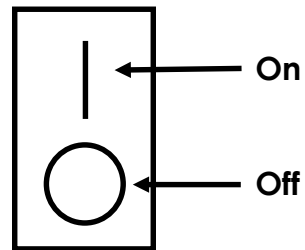

Operation

Throttle

To increase the output from the HYB5200, you need to increase the throttle.

1. Pull the Throttle Trigger on the Control Handle. Pull the trigger until you reach the desired airflow. Release the Trigger to return to idle speed
2. For each of use, there is a Trigger Lock Lever. When pulling the Throttle Trigger, push the Trigger Lock Lever upward. This will enable you to consistently hold the throttle without the need of excess effort.
3. To Release the Trigger Lock Lever, just press it downward, and the throttle will decrease.



Maintenance & Care

Air Filter

Replacing the Air filter is important maintenance for your HYB5200.

Dirty Air Filters Cause:

- More Fuel Use
- Machine Stalling
- Difficult Starting

Air Filter Replacement

! Ensure the Choke Lever is in Cold Start Position

1. Insert the included Hex key into the bolt at the bottom of the air filter housing.
2. Pull the air filter cover away from the left side gently, not to damage the Choke Lever.
3. Remove the air filter from it's seat.

Repeat these steps backwards to replace the air filter.



Continued on next page 

Maintenance & Care

Air Filter (Continued)

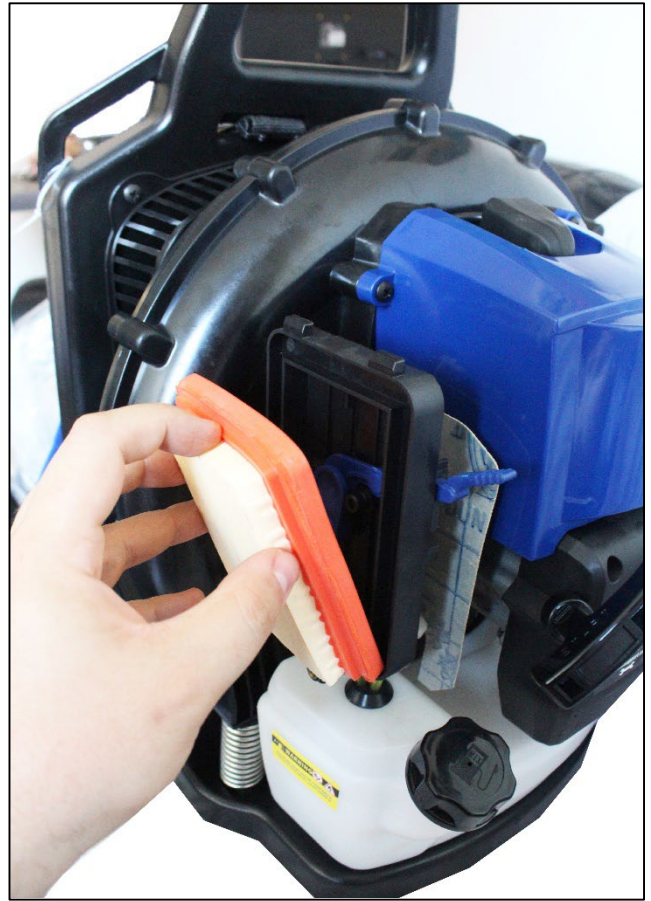

Maintenance & Care

Spark Plug

Replacing the Spark Plug is important maintenance for your HYB5200.

Dirty Spark Plugs Cause:

- More Fuel Use
- Machine Stalling
- Difficult Starting

Spark Plug Replacement

1. Remove the Spark Plug Cap. Be careful with this step not to pull the spark wire away from the Spark Connector.
2. Remove the Spark Connector. You can use the included flat headed screw driver to aid easing this off.
3. Use the included Box spanner to loosen the Spark plug. Turn the spark plug Anti-clockwise.
4. Remove the spark plug

Repeat these steps backwards to replace the sparkplug.

Acceptable Spark Plug gap is 0.6mm—0.7mm

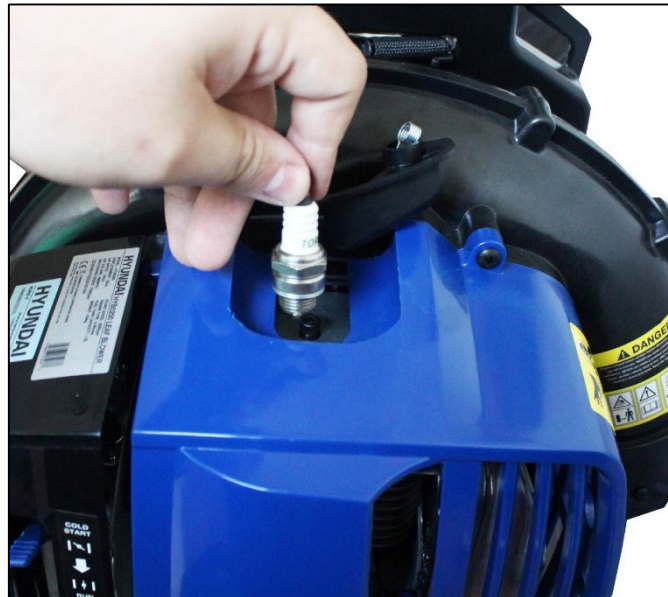

Continued on next page 

Maintenance & Care

Spark Plug (Continued)

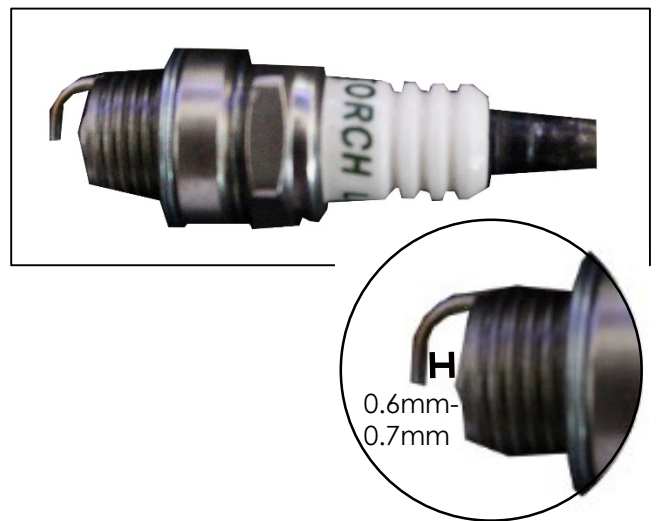
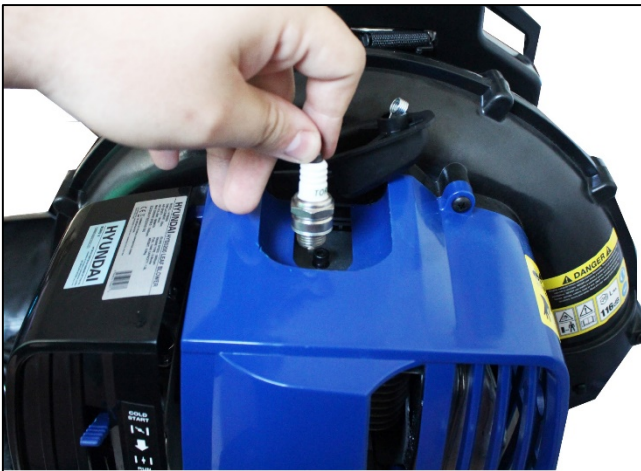

Maintenance & Care

Troubleshooting

	PROBLEM	POSSIBLE CAUSE	SOLUTION
The spark plug does not spark	Spark Plug	Spark plug electrode wet	Dry electrode
		Covered with carbon	Clean or replace the spark plug
		Damaged insulation	Replace spark plug
		Spark plug gap incorrect	Adjust the gap to 0.6 – 0.7mm
		Spark plug electrode burned	Replace spark plug
	Magneto	Damaged HT lead	Replace HT lead
		Bad coil insulation	Replace coil
		Damage to wire coil	Replace coil
Electronic firing unit is defective		Replace	
The spark plug functions correctly	Compression ratio OK and fueling well	Too much fuel in cylinder	Drain excess fuel
		Water or dirt in fuel or stale fuel	Replace with fresh fuel
	Fueling well but the compression ratio is poor	Piston ring worn or damaged	Replace worn or damaged items
		Spark plug is loose	Tighten spark plug
	Carburettor is not fuelling	No fuel in the tank	Refuel
		Filter gauze clogged	Clean filter gauze
		Tank air hole clogged	Clean tank air hole
Compression ratio is OK	Filter clogged	Clean/replace filter	
	Air is able to pass through	Tighten up to prevent air passing through	
	Carburettor leak	Tighten carburettor	
	Engine is overheating	Stop engine and allow to cool.	
	Water in fuel	Replace fuel	
	Carbon clogged exhaust	Clean exhaust	
Engine overheating	Fuel mixture too lean	Adjust the carburettor	
	Cylinder covered with carbon	Clean the cylinder	
Engine knocking or making a noise	Fuel has gone stale or bad	Change fuel	
	Carbon in cylinder	Clean the cylinder	
	Engine parts worn or damaged	Check and replace defective parts	
Engine stops suddenly	Piston Seized	Change piston	
	Spark plug covered in carbon	Clean plug, replace if necessary	
	Engine out of petrol	Refuel	

Maintenance & Care

General Maintenance

⚠ WARNING : Turn OFF the machine, allow all moving parts to come to a complete stop before maintaining the machine. You need to wear proper clothing and protective gloves whenever your hands are at risk.

- Keep all nuts, bolts and screws tight to be sure the machine is in a safe working condition.
- Replace worn or damaged parts for safety. Only use manufacturer-recommended parts and accessories.

Storage

⚠ Keep the machine stored in a dry, level area away from damp, moisture and rain fall. Allow the machine to cool down before storing.

- Make sure the machine is clean and dry before storing.
- Make sure the machine is stored away from direct sunlight. Store indoors or in a safe, locked protected area during severe weather and winter months. Do not expose to direct sunlight or unnecessarily long periods. UV rays can make the container material brittle, which could result in leaks or breakage.
- Ensure the machine is stored in a position, where any persons cannot step on to attempt to reach items up high, due to risk of movement.
- DO NOT store the machine near an ignition source, such as a wood stove, gas or electric heater, or an appliance or heater with a pilot light.
- Store the machine out of reach of children or anyone who is not familiar with operation.
- DO NOT stack other items on top of the machine when in storage.

3 Months & Longer

- Drain and clean the fuel tank in a well-ventilated area.
- Run engine until carburettor is dry – this helps prevent carburettor diaphragms sticking together.
- Thoroughly clean the machine – pay special attention to the cylinder fins and air filter.

Cleaning

⚠ Always remove the electric plug from the mains supply before any cleaning is undertaken.

- Remove any grass and mud after each use to prevent it from drying. Use a clean cloth to remove dirt, grease, etc.
- DO NOT use any water on any part of the main machine.
- Avoid using solvents when cleaning plastic parts. Most plastics are susceptible to damage from various types of commercial solvents and may be damaged by their use.
- Always ensure that ventilation openings are kept clear of debris.

Technical Data

Specification

Model	HYB5200
Length	870mm
Width	440mm
Height	505mm
Net Weight	9.8kg
Engine Type	Air Cooled, 2-Stroke, Single Cylinder
Engine Model	IC52-T
Carburettor	Diaphragm
Ignition System	Flywheel Magneto, Capacitor Discharge
Spark Plug	L7RTC Gap (0.6-0.7mm)
Exhaust System	Spark Arrestor Muffler
Fuel	Mixed (Petrol & 2-Stroke Oil)
Oil	40:1 Semi-Synthetic 2-Stroke Oil & Unleaded Petrol or Aspen2 Fuel
Idle Speed	3000/min
Max. Speed	7500/min
Displacement	52cm ³
Air Volume	890m ³ /h
Air Speed	18m/s
Power	1.45kW
Measured Sound Pressure Level	98.5dB(A) K=3dB(A)
Measured Sound Power Level	108.3dB(A) K=3dB(A)
Guaranteed Sound Power Level	116dB(A)
Vibration Level	4.194m/s ² K=1.5m/s ²

Recycling & Disposal

Recycling & Disposal

We do not offer a takeback scheme for the recovery of Waste Electrical Electronic Equipment (WEEE) & Batteries. Instead the responsibility to dispose of WEEE and/or Batteries is passed onto you by us.

So when it becomes necessary to dispose of your machine you must take it to your local Civic Amenity Site. For further information please contact your local Authority for disposal advice.

You **MUST** make sure that all unused oil and fuel is disposed of correctly either beforehand or at your local Civic Amenity Site.

- Under NO circumstances must any fuel or oil be put down any drains.
- Certain products contain WEEE waste which should not be disposed of in your domestic waste.
- You **MUST** recycle WEEE in accordance with your local authority or recycling centre.
- Certain products contain batteries which should not be disposed of in your domestic waste.
- You **MUST** recycle batteries in accordance with your local authority or recycling centre.
- Unwanted packaging and materials should be stored and taken to a recycling centre so it can be disposed of in a manner which is compatible with the environment.

We are a Member of the VALPAK National Compliance Scheme and our registration number is RM08660. For further information about disposal please contact your Local Authority.

You can also get more advice and guidance about recycling at the following website <http://www.recycle-more.co.uk>

Should you pass this product on to another user either sold or loaned, you **MUST** pass on this user manual. This will make sure that all other users can use and maintain this machine safely.

Environmental Protection

1. Environmental protection should be a priority of considerable importance when using the machine, for the benefit of both social coexistence and the environment in which we live. Try not to cause any disturbance to the surrounding area.
2. You must comply with local regulations and provisions for the disposal of packaging, oils, fuel, filters, damaged parts or any elements which have a strong impact on the environment. This waste must not be disposed of as normal waste. It needs to be separated and taken to specified waste disposal centres where the material will be recycled.
3. You must comply with local regulations for the disposal of waste materials after mowing.
4. When disposing, do not pollute the environment with the machine, but hand it over to a disposal centre, in accordance with the local laws in force.

Declaration Of Conformity

Importer and Authorised Representative

Genpower Ltd
Isaac Way, Pembroke Dock, SA72 4RW

Country of Origin: China

Description: Leaf Blower

SKU Code: HYB5200

Date of Issue: 23/07/2021

Regulations and Directives of Compliance

- 2006/42/EC The Machine Directive
- 2014/30/EU EMC Directive
- 2016/1628/EC The Emission of Gaseous and Particulate Pollutants from internal Combustion engines
- 2000/14/EC Noise Emissions

Statement of Declaration

We the importer and authorised representative of the product described confirm conformity within the provisions of applicable regulations and directives listed within this document.

Signed on Behalf of Genpower Ltd

Place of Issue: Genpower Ltd

Signatory Name: Roland Llewellyn

Position: Managing Director

R J Llewellyn
.....



Useful Information

Check Out Our YouTube Channel

Our videos on YouTube include:

- Unboxing
- Assembly of your machine
- How to service your machine
- Products in use
- 'How To' videos
- Product features

Go to YouTube and search '**Hyundai Power Products**'.

Warranty

Proof of purchase will be required before you make a warranty claim. Full warranty terms and conditions can be found on the HYUNDAI POWER PRODUCTS website:

www.hyundaipowerproducts.co.uk

Manual Updates

Our manuals are constantly being reviewed and updated. Should you find an error, omission or something unclear, please contact us for assistance. We reserve the right to make any modifications without prior notice whenever necessary. Our latest manuals are also placed online. All our manuals can be downloaded at:
www.hyundaipowerproducts.co.uk

Returning Your Product

If you are returning your product, please contact the dealer for their returns policy.

Leaving A Review

We work very hard to give all of our customers the best possible service. If you have any problems, before leaving negative feedback, please contact us to give us a chance to resolve the issue. We would be delighted if you left us positive feedback! To leave a review, please go to:

uk.trustpilot.com/review/hyundaipowerequipment.co.uk

Ordering Spare Parts

You can find the spare part you are looking for at **power-spare.co.uk**

Product Record

Information

As soon as you have purchased the machine, we recommend that you fill out the following. If you need to contact an authorised dealer or customer service for information on servicing, you may need to provide the following information.

Date Of Purchase:.....

Dealer Name:.....

Dealer Phone:.....

Model Number:.....

Serial / Batch Number:.....

Contact Us

Need Help? Talk To Our Experts

Our friendly aftersales team will be more than happy to help you.



Phone

Call our team on 01646 687 880



Email

aftersales@hyundaipowerproducts.co.uk



Online Live Chat

Go to www.hyundaipowerproducts.co.uk



Post

Genpower Ltd, Isaac Way, Pembroke Dock, Pembrokeshire, SA72 4RW.



Hyundai Support Website

Go to hyundaisupport.co.uk

HYUNDAI

POWER PRODUCTS

Importer:

GENPOWER LTD

Isaac Way, London Road,
Pembroke Dock, UK, SA72 4RW.

T: +44 (0) 1646 687 880

E: info@hyundaipowerproducts.co.uk

www.hyundaipowerproducts.co.uk

Imported / Distributed by Genpower Ltd for the United Kingdom & Ireland

Licensed by Hyundai Corporation, Korea